

A66 Northern Trans-Pennine Project

Scheme 03: Penrith to Temple Sowerby

TR010062

General Scheme Outline Plans

Response to ExA's Procedural Decision PD-006 in Rule 6 Letter

November 2022

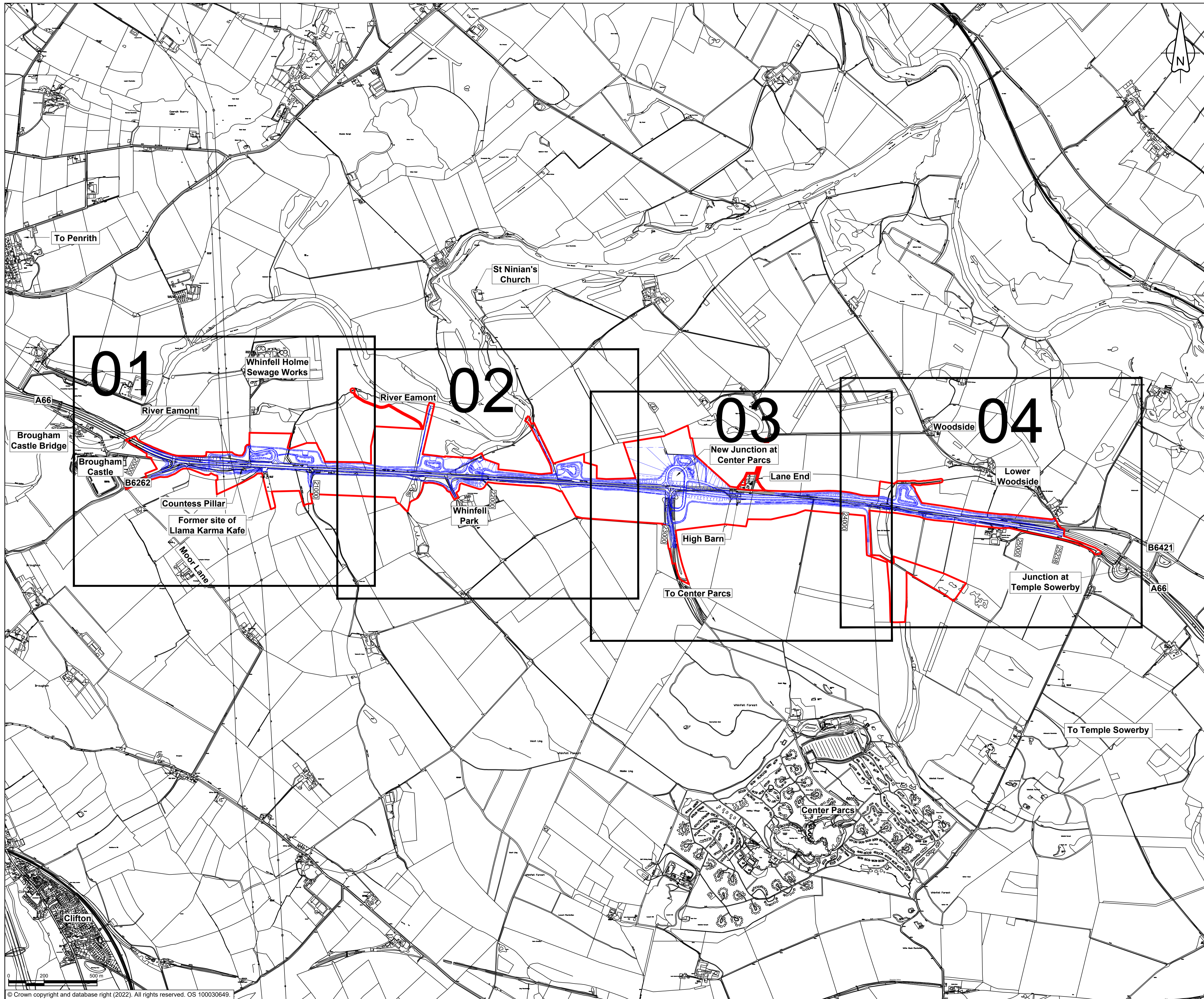

- NOTES**
 1. ALL DIMENSIONS ARE IN METRES UNLESS NOTED OTHERWISE.
- KEY**
- THE SCHEME (SHOWN FOR ILLUSTRATIVE PURPOSES ONLY)
 - SHEET USED AS PART OF THIS DRAWING SERIES
 - CHAINAGE (MEASURED DISTANCE ALONG THE SCHEME LENGTH)
 - ORDER LIMITS



C01	ASCO	ASCO	JJAS	DKID	SBAG
	14/11/22	14/11/22	14/11/22	14/11/22	14/11/22
Revision details					
Revision	Created	Checked	Reviewed	Approved	Authorised
	dd/mm/yy	dd/mm/yy	dd/mm/yy	dd/mm/yy	dd/mm/yy

Purpose
 Response to ExA's Procedural Decision PD-006 in Rule 6 Letter

PINS Reference Number
 TR010062

Client
 3 Piccadilly Place
 Manchester
 M1 3BN



Project Name / Scheme Name
**A66 Northern Trans-Pennine Project
 Scheme 03
 Penrith to Temple Sowerby**

Drawing Title
**General Scheme Outline Plans
 Submitted in response to PD-006
 Key Plan**

Project Ref. No.	Stage	Scale :	1:10000	@ A1
---	PCF3	Dimensions :	M	

Drawing Number	Project	Originator	Volume
HE565627 - AMY - HAC -			
S03	-DR-CH-	200005	
Location	Type	Role	Number

Suitability	Suitability Description	Revision
A	Approved for Stage Complete	C01

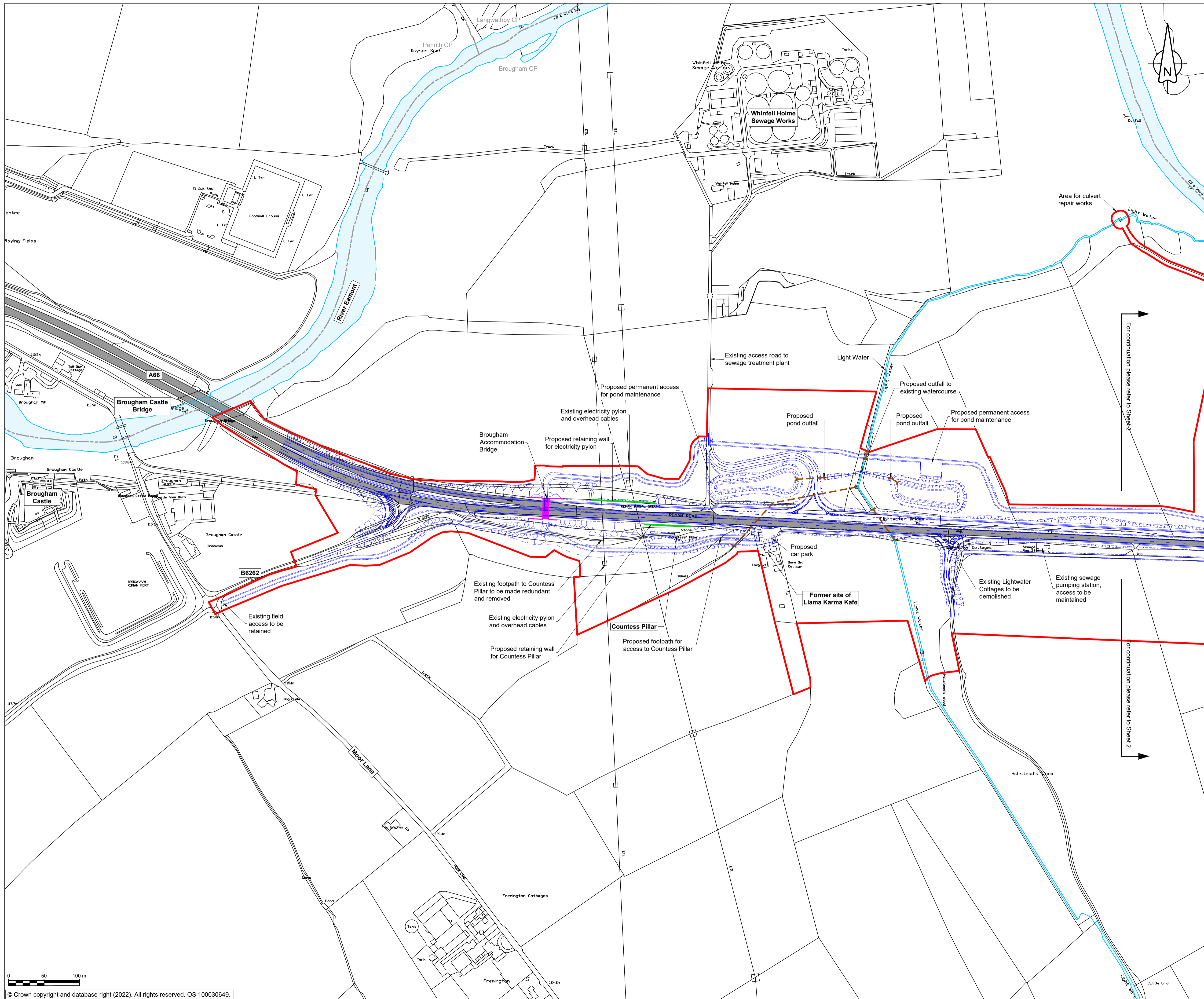

- ### NOTES
1. ALL DIMENSIONS ARE IN METRES UNLESS NOTED OTHERWISE.
 2. FOR ENVIRONMENTAL DETAILS REFER TO THE ENVIRONMENTAL MASTERPLAN AND ASSOCIATED DRAWINGS/DOCUMENTS.
 3. THE DESIGN OF THE SCHEME IS SHOWN HERE FOR ILLUSTRATIVE PURPOSES ONLY AND WILL BE SUBJECT TO DETAILED DESIGN DEVELOPMENT IN ACCORDANCE WITH THE PROVISIONS OF THE DEVELOPMENT CONSENT ORDER.
 4. THESE PLANS SHOULD BE READ IN CONJUNCTION WITH RIGHTS OF WAY AND ACCESS PLANS.

- ### KEY
- ORDER LIMITS
 - AREA EXCLUDED FROM ORDER LIMITS
 - AREA OF OUTSTANDING NATURAL BEAUTY (AONB)
 - EXISTING WATERCOURSE
 - EXISTING A66 CARRIAGEWAY
 - PARISH BOUNDARY
 - EXISTING PUBLIC RIGHT OF WAY
 - PROPOSED WORKS
 - PROPOSED EARTHWORKS
 - PROPOSED CULVERT & HEADWALL
 - PROPOSED RETAINING STRUCTURE
 - PROPOSED BRIDGE / VIADUCT
 - PROPOSED UNDERPASS / TUNNEL

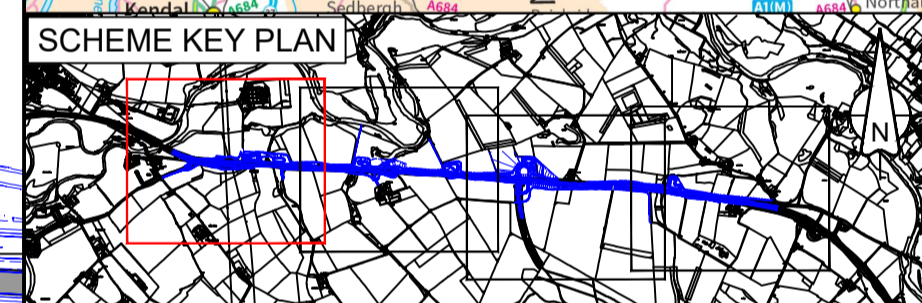
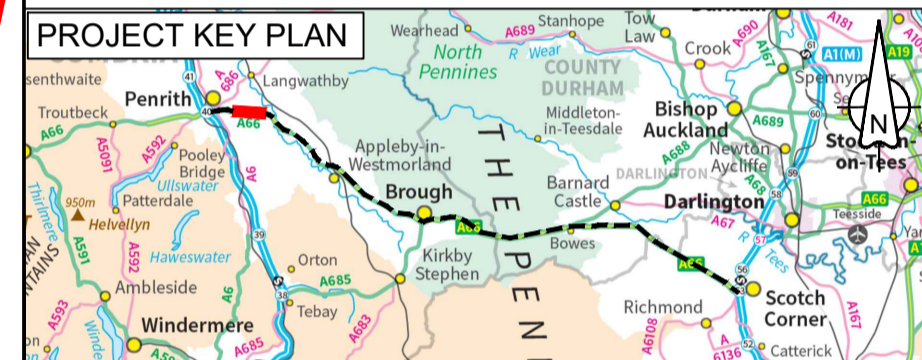

C01	ASCO	ASCO	JJAS	DKID	SBAG
	14/11/22	14/11/22	14/11/22	14/11/22	14/11/22
Revision details					
Revision	Created	Checked	Reviewed	Approved	Authorised
	dd/mm/yy	dd/mm/yy	dd/mm/yy	dd/mm/yy	dd/mm/yy

Purpose
Response to ExA's Procedural Decision PD-006 in Rule 6 Letter

PINS Reference Number
TR010062

Client
3 Piccadilly Place
Manchester
M1 3BN

Project Name / Scheme Name
**A66 Northern Trans-Pennine Project
Scheme 03
Penrith to Temple Sowerby**

Drawing Title
**General Scheme Outline Plans
Submitted in response to PD-006
Sheet 1 of 4**

Project Ref. No.	Stage	Scale :	@ A1
---	PCF3	1:2500	
		Dimensions :	M

Drawing Number	Project	Originator	Volume
HE565627 - AMY - HAC -			
S03	-DR-CH-	200006	
Location	Type	Role	Number

Suitability	Suitability Description	Revision
A	Approved for Stage Complete	C01

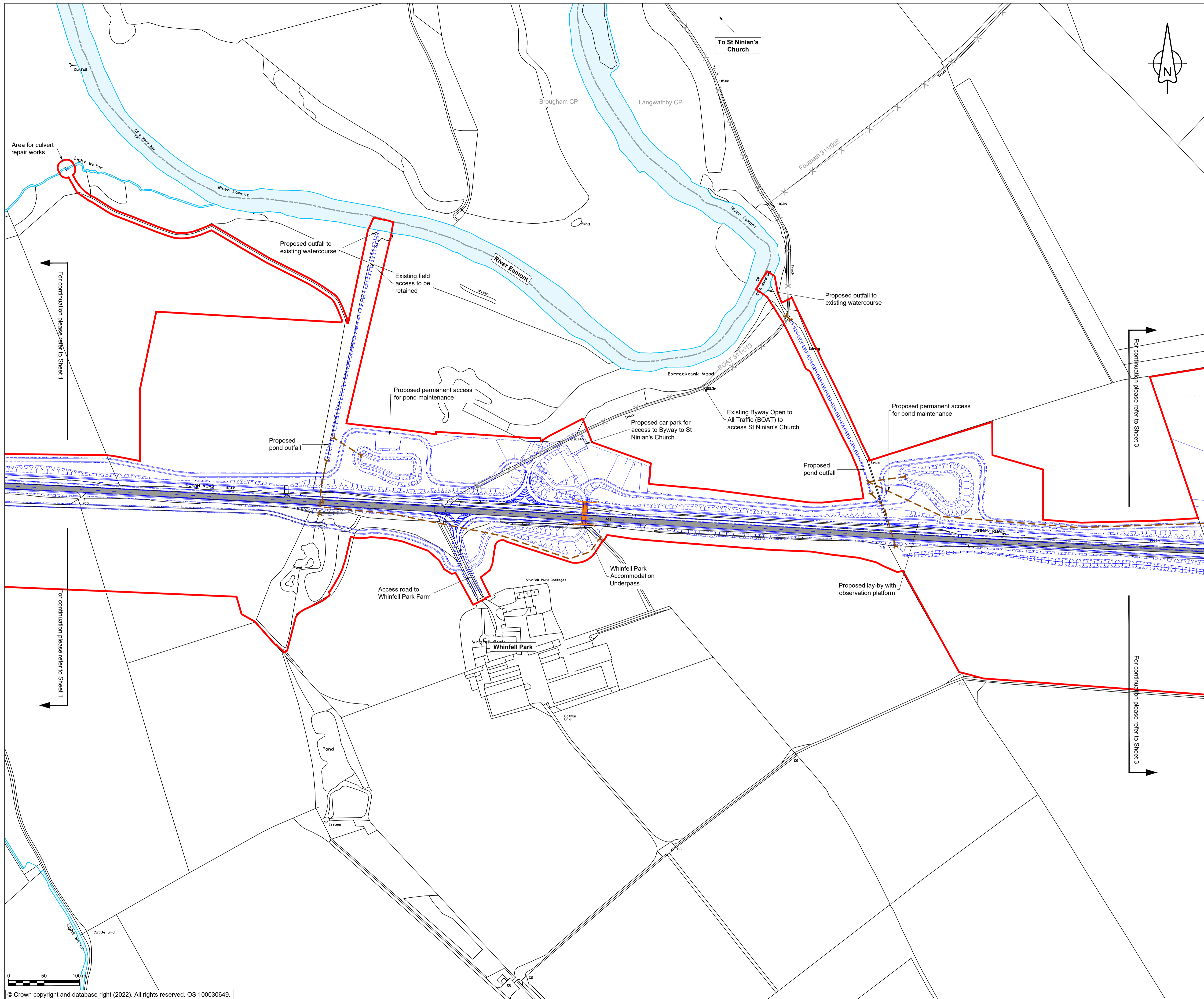

- ### NOTES
1. ALL DIMENSIONS ARE IN METRES UNLESS NOTED OTHERWISE.
 2. FOR ENVIRONMENTAL DETAILS REFER TO THE ENVIRONMENTAL MASTERPLAN AND ASSOCIATED DRAWINGS/DOCUMENTS.
 3. THE DESIGN OF THE SCHEME IS SHOWN HERE FOR ILLUSTRATIVE PURPOSES ONLY AND WILL BE SUBJECT TO DETAILED DESIGN DEVELOPMENT IN ACCORDANCE WITH THE PROVISIONS OF THE DEVELOPMENT CONSENT ORDER.
 4. THESE PLANS SHOULD BE READ IN CONJUNCTION WITH RIGHTS OF WAY AND ACCESS PLANS.

- ### KEY
- ORDER LIMITS
 - AREA EXCLUDED FROM ORDER LIMITS
 - AREA OF OUTSTANDING NATURAL BEAUTY (AONB)
 - EXISTING WATERCOURSE
 - EXISTING A66 CARRIAGEWAY
 - PARISH BOUNDARY
 - EXISTING PUBLIC RIGHT OF WAY
 - PROPOSED WORKS
 - PROPOSED EARTHWORKS
 - PROPOSED CULVERT & HEADWALL
 - PROPOSED RETAINING STRUCTURE
 - PROPOSED BRIDGE / VIADUCT
 - PROPOSED UNDERPASS / TUNNEL

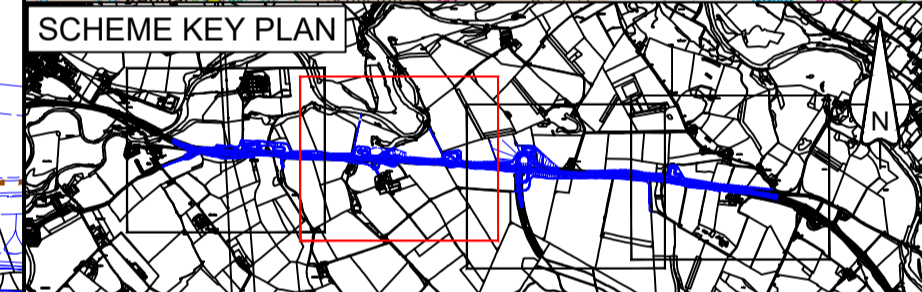
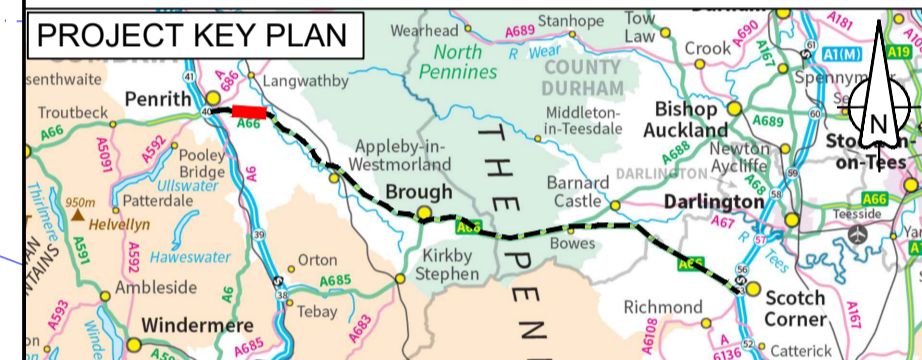

C01	ASCO	ASCO	JJAS	DKID	SBAG
	14/11/22	14/11/22	14/11/22	14/11/22	14/11/22
Revision details					
Revision	Created	Checked	Reviewed	Approved	Authorised
	dd/mm/yy	dd/mm/yy	dd/mm/yy	dd/mm/yy	dd/mm/yy

Purpose
Response to ExA's Procedural Decision PD-006 in Rule 6 Letter

PINS Reference Number
TR010062

Client
3 Piccadilly Place
Manchester
M1 3BN



Project Name / Scheme Name
**A66 Northern Trans-Pennine Project
Scheme 03
Penrith to Temple Sowerby**

Drawing Title
**General Scheme Outline Plans
Submitted in response to PD-006
Sheet 2 of 4**

Project Ref. No.	Stage	Scale :	@ A1
---	PCF3	1:2500	
		Dimensions :	M

Drawing Number	Project	Originator	Volume
HE565627 - AMY - HAC -			
S03	-DR-CH-	200007	
Location	Type	Role	Number

Suitability	Suitability Description	Revision
A	Approved for Stage Complete	C01

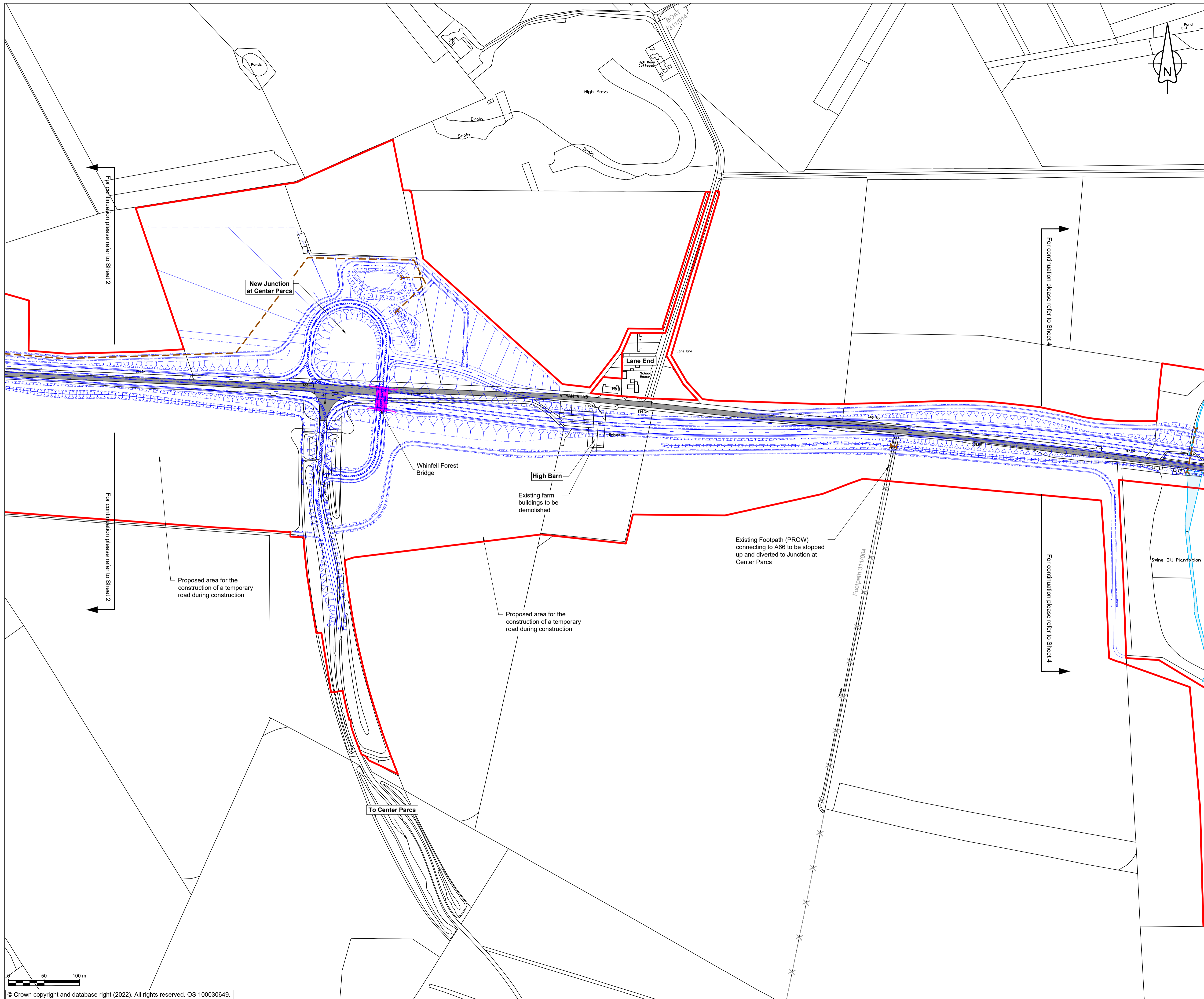

- ### NOTES
1. ALL DIMENSIONS ARE IN METRES UNLESS NOTED OTHERWISE.
 2. FOR ENVIRONMENTAL DETAILS REFER TO THE ENVIRONMENTAL MASTERPLAN AND ASSOCIATED DRAWINGS/DOCUMENTS.
 3. THE DESIGN OF THE SCHEME IS SHOWN HERE FOR ILLUSTRATIVE PURPOSES ONLY AND WILL BE SUBJECT TO DETAILED DESIGN DEVELOPMENT IN ACCORDANCE WITH THE PROVISIONS OF THE DEVELOPMENT CONSENT ORDER.
 4. THESE PLANS SHOULD BE READ IN CONJUNCTION WITH RIGHTS OF WAY AND ACCESS PLANS.

- ### KEY
- ORDER LIMITS
 - AREA EXCLUDED FROM ORDER LIMITS
 - AREA OF OUTSTANDING NATURAL BEAUTY (AONB)
 - EXISTING WATERCOURSE
 - EXISTING A66 CARRIAGEWAY
 - PARISH BOUNDARY
 - EXISTING PUBLIC RIGHT OF WAY
 - PROPOSED WORKS
 - PROPOSED EARTHWORKS
 - PROPOSED CULVERT & HEADWALL
 - PROPOSED RETAINING STRUCTURE
 - PROPOSED BRIDGE / VIADUCT
 - PROPOSED UNDERPASS / TUNNEL

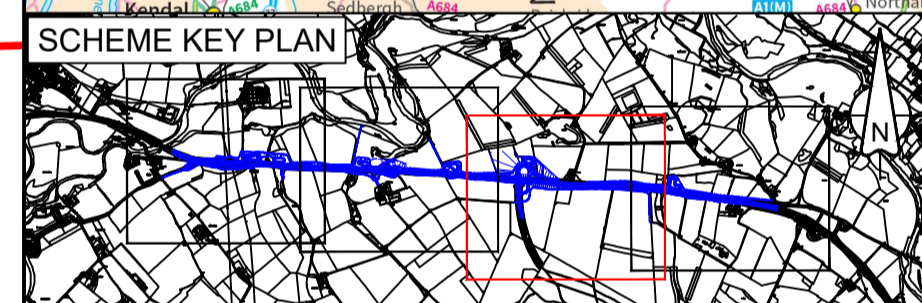
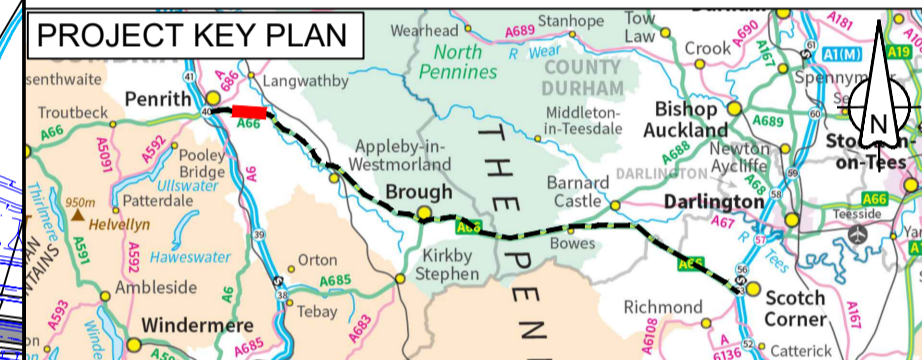

C01	ASCO	ASCO	JJAS	DKID	SBAG
	14/11/22	14/11/22	14/11/22	14/11/22	14/11/22
Revision details					
Revision	Created	Checked	Reviewed	Approved	Authorised
	dd/mm/yy	dd/mm/yy	dd/mm/yy	dd/mm/yy	dd/mm/yy

Purpose
Response to ExA's Procedural Decision PD-006 in Rule 6 Letter

PINS Reference Number
TR010062

Client
3 Piccadilly Place
Manchester
M1 3BN



Project Name / Scheme Name
**A66 Northern Trans-Pennine Project
Scheme 03
Penrith to Temple Sowerby**

Drawing Title
**General Scheme Outline Plans
Submitted in response to PD-006
Sheet 3 of 4**

Project Ref. No.	Stage	Scale	@ A1
---	PCF3	1:2500	
		Dimensions	M

Drawing Number			
Project	Originator	Volume	
HE565627	AMY	HAC	
S03	-DR-CH-		200008
Location	Type	Role	Number

Suitability	Suitability Description	Revision
A	Approved for Stage Complete	C01

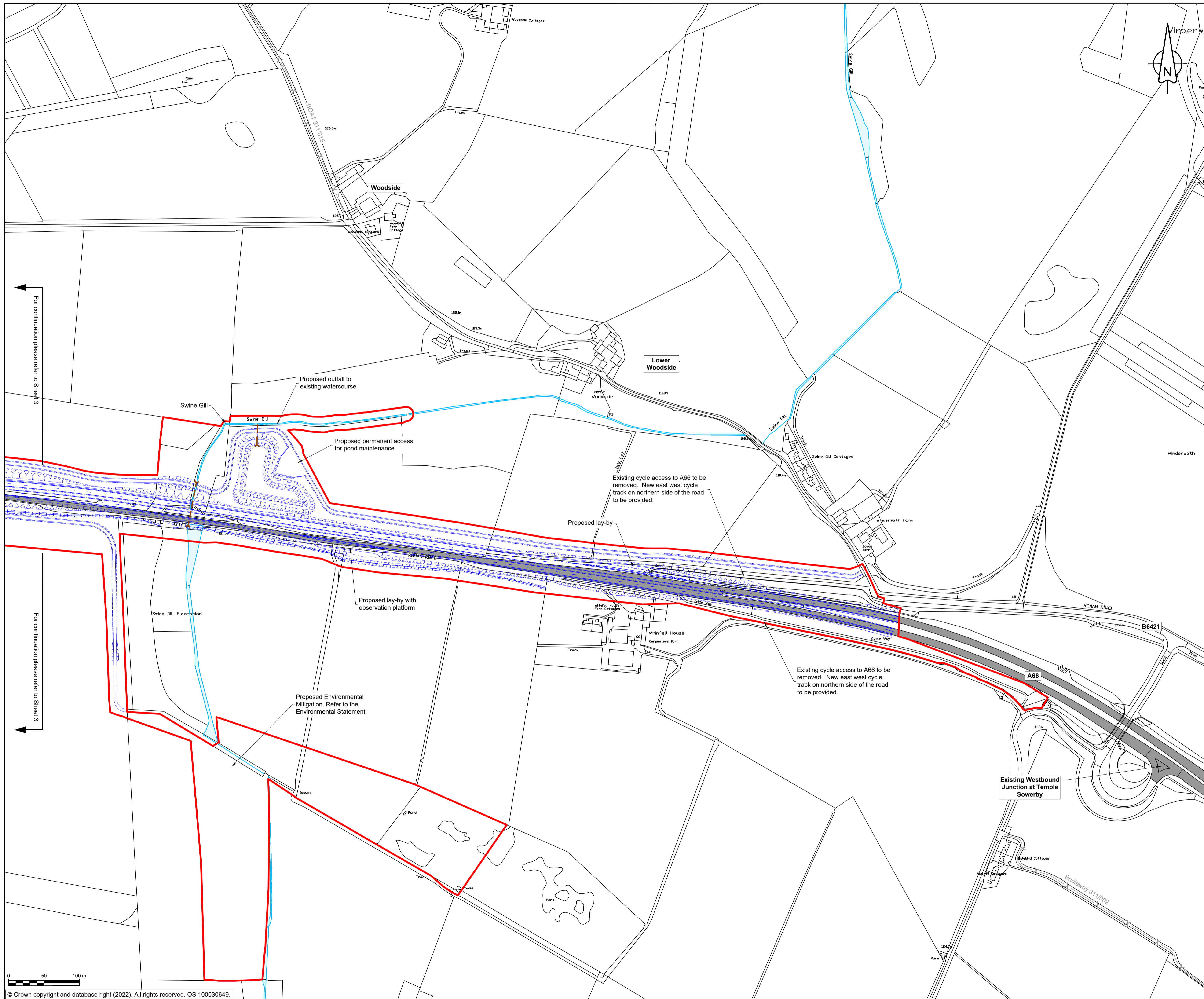

- ### NOTES
1. ALL DIMENSIONS ARE IN METRES UNLESS NOTED OTHERWISE.
 2. FOR ENVIRONMENTAL DETAILS REFER TO THE ENVIRONMENTAL MASTERPLAN AND ASSOCIATED DRAWINGS/DOCUMENTS.
 3. THE DESIGN OF THE SCHEME IS SHOWN HERE FOR ILLUSTRATIVE PURPOSES ONLY AND WILL BE SUBJECT TO DETAILED DESIGN DEVELOPMENT IN ACCORDANCE WITH THE PROVISIONS OF THE DEVELOPMENT CONSENT ORDER.
 4. THESE PLANS SHOULD BE READ IN CONJUNCTION WITH RIGHTS OF WAY AND ACCESS PLANS.

- ### KEY
- ORDER LIMITS
 - AREA EXCLUDED FROM ORDER LIMITS
 - AREA OF OUTSTANDING NATURAL BEAUTY (AONB)
 - EXISTING WATERCOURSE
 - EXISTING A66 CARRIAGEWAY
 - PARISH BOUNDARY
 - EXISTING PUBLIC RIGHT OF WAY
 - PROPOSED WORKS
 - PROPOSED EARTHWORKS
 - PROPOSED CULVERT & HEADWALL
 - PROPOSED RETAINING STRUCTURE
 - PROPOSED BRIDGE / VIADUCT
 - PROPOSED UNDERPASS / TUNNEL

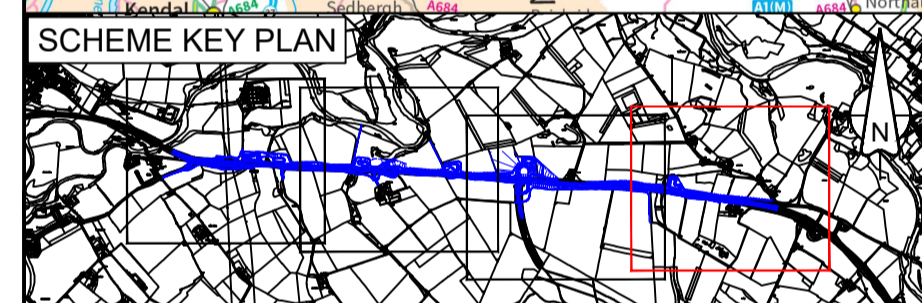
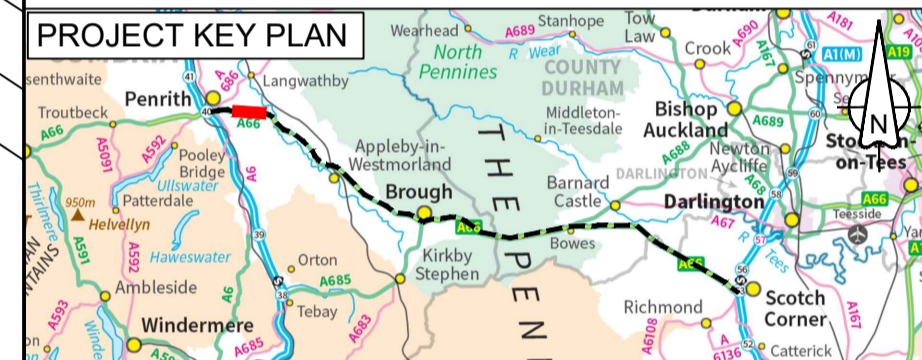

C01	ASCO	ASCO	JJAS	DKID	SBAG
	14/11/22	14/11/22	14/11/22	14/11/22	14/11/22
Revision details					
Revision	Created	Checked	Reviewed	Approved	Authorised
	dd/mm/yy	dd/mm/yy	dd/mm/yy	dd/mm/yy	dd/mm/yy

Purpose
Response to ExA's Procedural Decision PD-006 in Rule 6 Letter

PINS Reference Number
TR010062

Client
3 Piccadilly Place
Manchester
M1 3BN



Project Name / Scheme Name
**A66 Northern Trans-Pennine Project
Scheme 03
Penrith to Temple Sowerby**

Drawing Title
**General Scheme Outline Plans
Submitted in response to PD-006
Sheet 4 of 4**

Project Ref. No.	Stage	Scale	@ A1
---	PCF3	1:2500	
		Dimensions	M

Drawing Number	Project	Originator	Volume
HE565627	- AMY -	HAC -	
S03	-DR-CH-	200009	
Location	Type	Role	Number

Suitability	Suitability Description	Revision
A	Approved for Stage Complete	C01